

EMERGENCY KIT PANEL/DOWNLIGHT 3H AUTOTEST

KEY FEATURES

Emergency kit for LED Panels and Downlights.



3 PRAGMALUX
YEAR
WARRANTY



STANDARDS

IEC 61347-1
IEC 61347-2-7
EN 62034
EN 55015
EN 61547
EN 61000-3-2
EN 61000-3-3
EN 62493
AS/NZS 60598-2-22
AS2293.3

TECHNICAL DATA

- Input rated voltage: 220-240V AC, 50-60Hz
- AC input current: 50mA max
- AC Input power rated 4.0 W max
- Power factor: >0.5
- Charge time : 16 hours
- Charge mode: trickle re-charging on battery.
- Output emergency power 3 Watt DC10...50V (3-15 LEDs) constant power output.
- Output voltage DC10...50V, DC55V max(SELV)
- Battery capacity (LiFePO4) 2200mAh
- Battery Charging Current: 0-250mA
- 3 hours rated duration
- Max. casing temperature tc 70°C
- Lumen Factor: 120lm/W - 360lm

DETAILS

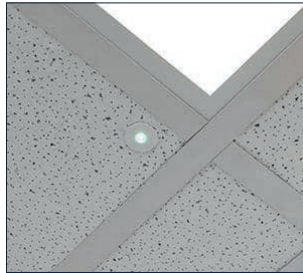

SPECIFICATIONS

ITEM CODE	DESCRIPTION
1000282	Emergency Kit for Panels & Downlights 3 Hours Autotest

DIMENSIONS

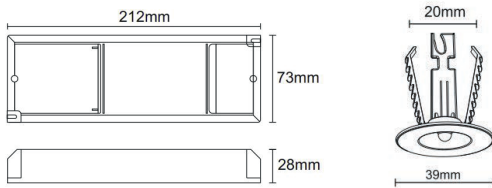

WIRING DIAGRAM

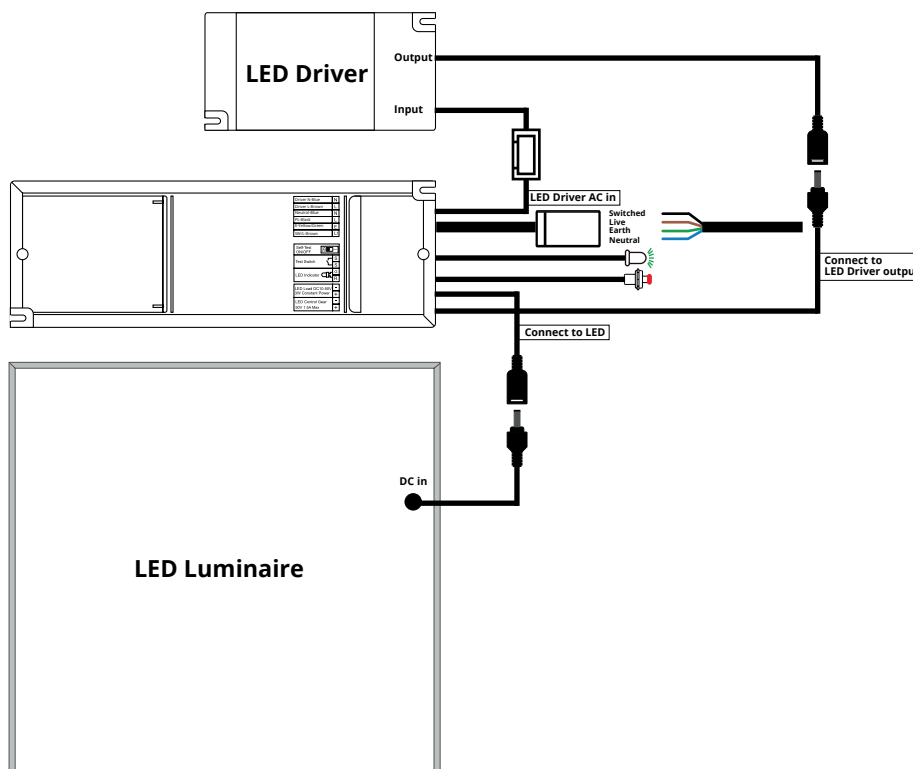

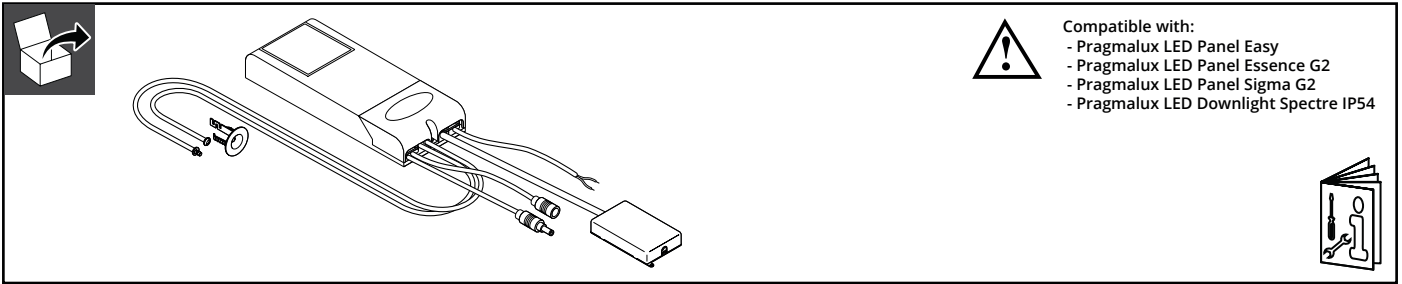

Compatible with:
 - Pragmalux LED Panel Easy
 - Pragmalux LED Panel Essence G2
 - Pragmalux LED Panel Sigma G2
 - Pragmalux LED Downlight Spectre IP54

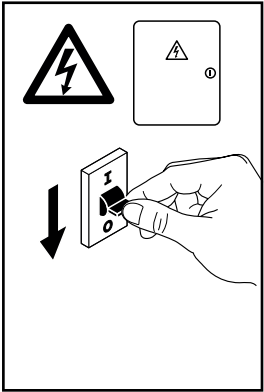

Installation date

1	2	3	4	5	6	7	8	9	10	11	12
2021	2022	2023	2024	2025	2026						

1	2	3	4	5	6	7	8	9	10	11	12
2021	2022	2023	2024	2025	2026						

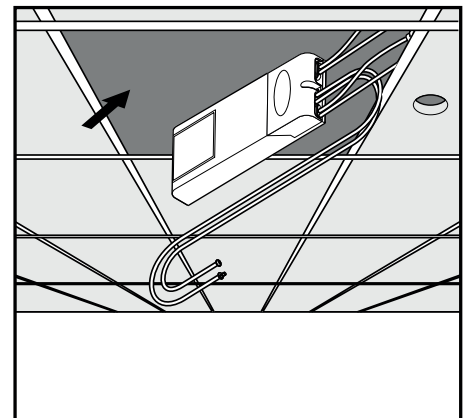
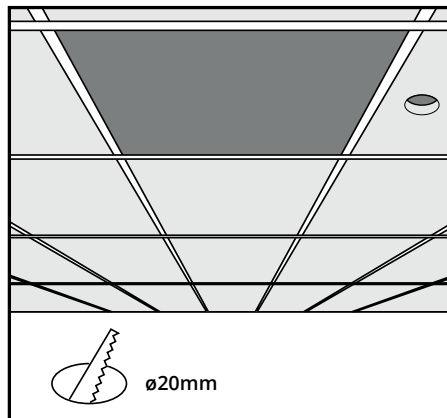
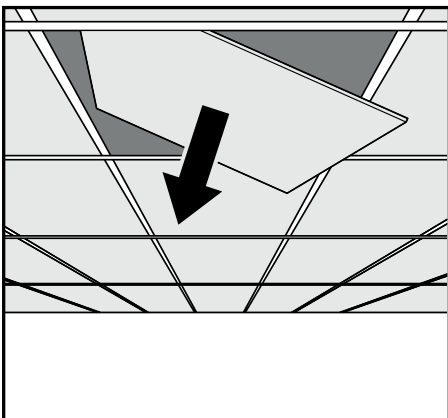
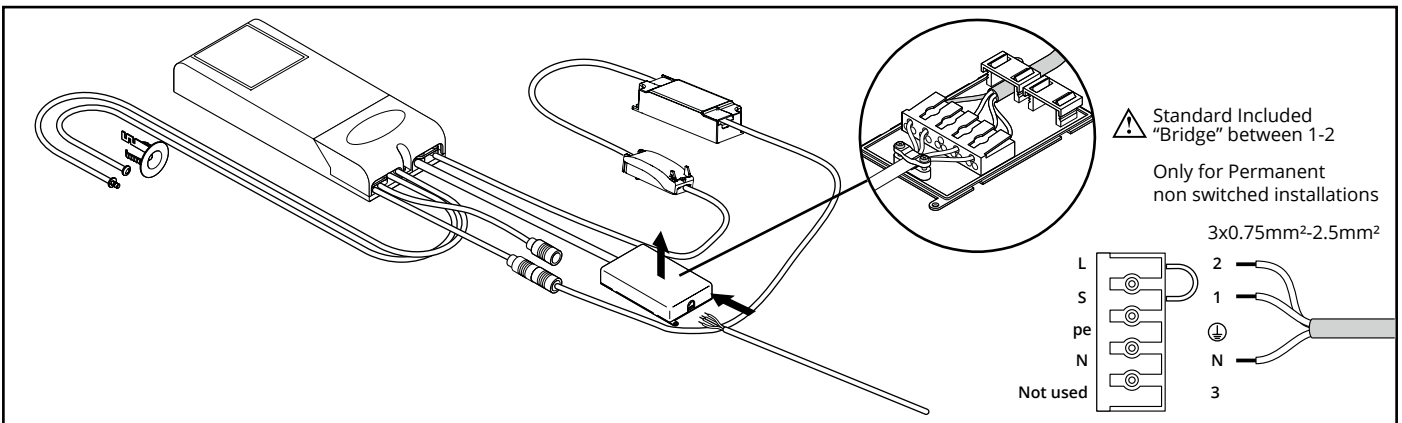
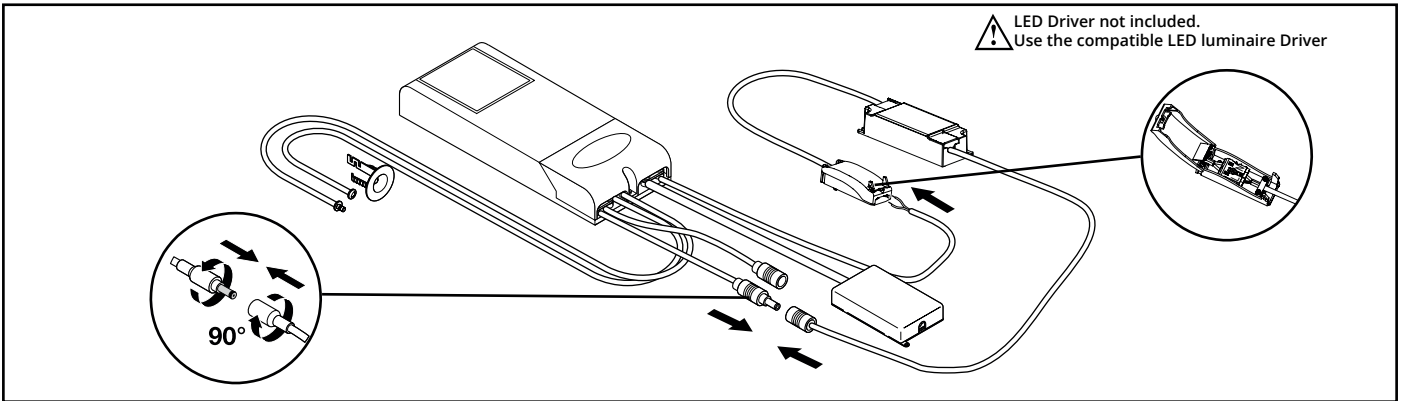

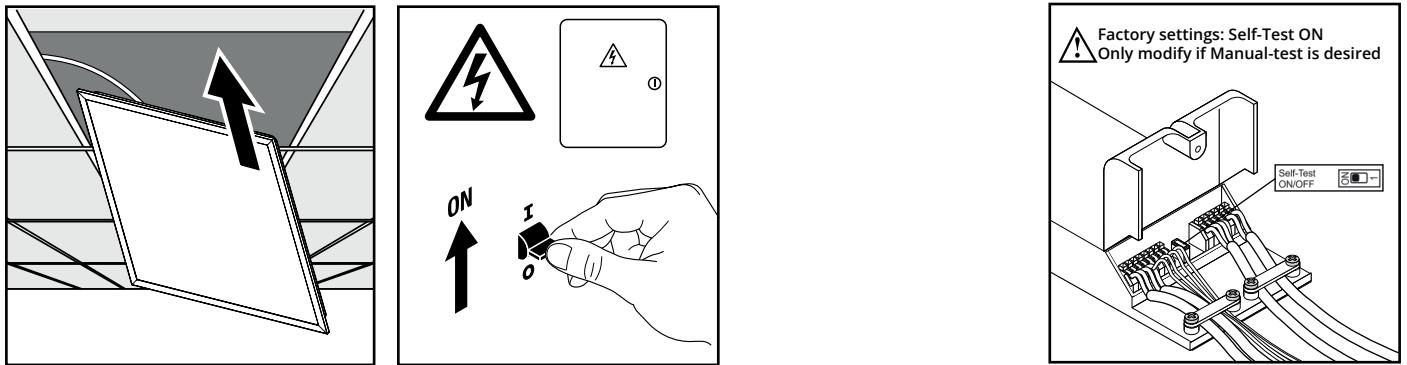
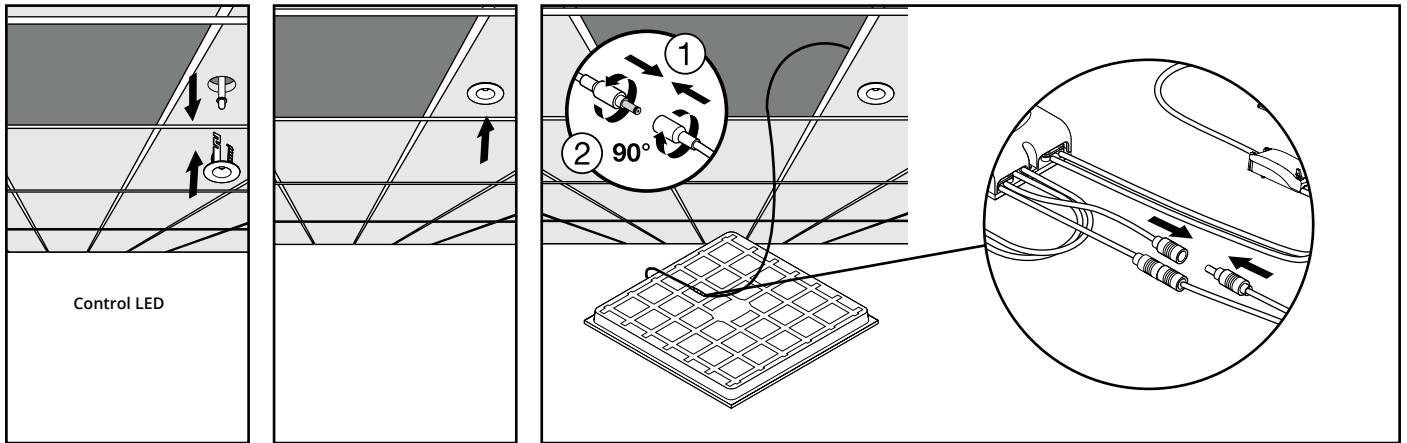

Self-test

Initial test / Initiële test

EN - Connect the led load, emergency module, battery and led driver, then connect the mains supply. The emergency conversion module will automatically start to do an initial test, checking if the led load, battery, led driver and emergency module itself are working properly or not. If not, the red led indicator would start flashing. If the initial test went properly, the kit will go on charging mode.

NL - Sluit het led armatuur (led load), noodmodule, batterij en led-driver aan en sluit vervolgens de netvoeding aan. De noodconversiemodule (converter) begint automatisch een eerste test uit te voeren en controleert of het armatuur, batterij, led-driver en noodmodule naar behoren functioneren of niet. Zo niet, dan knippert de led-indicator rood. Als de eerste test goed is verlopen, gaat de kit in de oplaadmodus.

Functional test / Functietest

EN - Functional tests are carried out automatically every 30 days, for 10 seconds.

NL - Functionele tests worden elke 30 dagen automatisch uitgevoerd gedurende 10 seconden.

Duration test / Autonomietest

EN - The emergency conversion module will automatically make a full duration test every 180 calendar days to check the battery capacity.

NL - De noodconversiemodule voert elke 180 kalenderdagen automatisch een volledige autonomietest/duurtest uit om de batterijcapaciteit te controleren.

Note / Aandachtspunten

EN - If the main supply is off during the self-test period, the emergency conversion module would immediately finish the self-test and it will go into the emergency mode.

NL - Als de hoofdvoeding tijdens de zelftestperiode is uitgeschakeld, voltooit de noodconversiemodule (converter) de zelftest onmiddellijk en gaat deze in de noodmodus.

Timer reset functionality / Timer reset-functie

EN - The function and duration timer test can be set into a particular time of the day, by cycling the un-switched line supply 3 times within 1 minute.

NL - De functie- en duurtimertest kan worden ingesteld op een bepaalde tijd van de dag, door de voeding 3 keer aan en uit te zetten binnen 1 minuut.

Rest mode / Rustmodus







EN - Rest mode can be initiated during the emergency mode, by pressing the test button for more than 3 seconds.

NL - De rustmodus kan worden ingeschakeld tijdens de noodmodus door de testknop langer dan 3 seconden ingedrukt te houden.

Manual-test

The test button is an open switch, if it's pressed it connects, after it's release, it cuts off automatically. When doing the daily maintenance, if the button is pressed, the emergency driver goes into emergency mode, if the button is released, the emergency driver will go back to normal mode.

LED Indicator

-  Green fast flash (0.1 second on, 0.1 second off), function test
Groen snelle flits (0.1 second aan, 0.1 second uit), functietest
-  Green slow flash (1 second on, 1 second off), duration test
Groen langzame flits (1 second aan, 1 second uit), duurtest
-  Green stable: battery fully charged
Groen permanent aan: normale status
-  Red flash, failure (battery failure)
Rood flits, fout (batterijfout)
-  Red permanent, failure (lamp/load failure)
Rood, fout (lamp-/laadfout)
-  Green and red off, DC mode (battery operation, emergency mode)
Uit, DC mode (Noodmodus, bij stroomuitval)

Warning

Only qualified electrician is allowed to do installation, maintenance and inspection for safety concern. It is dangerous for non-professional operators.

Power should be cut off before installation, maintenance or inspection.

Please install and use the product strictly according to the instruction.

Do not disassemble or remold the product at will to avoid accident of electric shock or light falling.